

GT325 PRINCIPAL PARTICULARS

LENGTH OVERALL: 9.97 m 32' 8"  
 LENGTH ON DECK: 9.53 m 31' 3"  
 WATERLINE LENGTH: 9.00 m 29' 6"  
 BEAM OVERALL: 3.56 m 11' 8"  
 DRAUGHT (BILGE KEELS): 1.42 m 4' 8"  
 DISPLACEMENT: 5,650 kg

# GT325

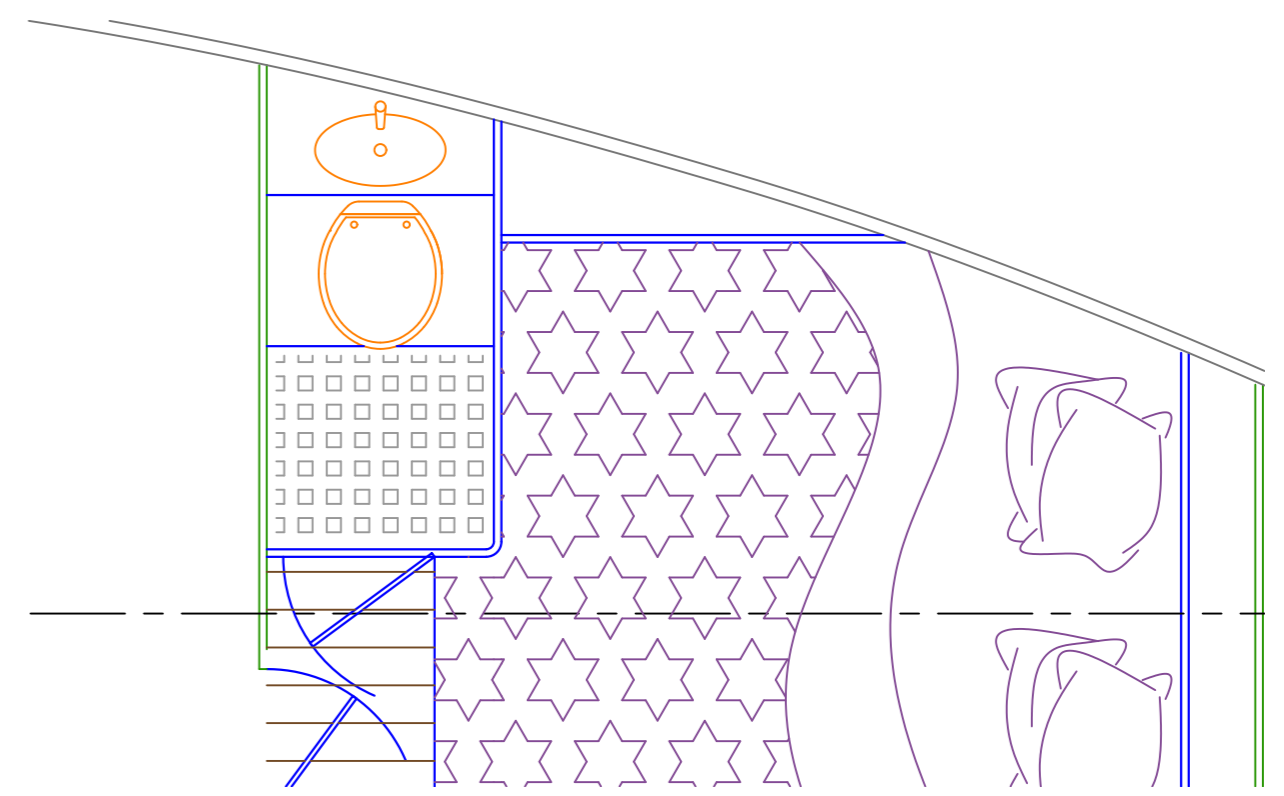
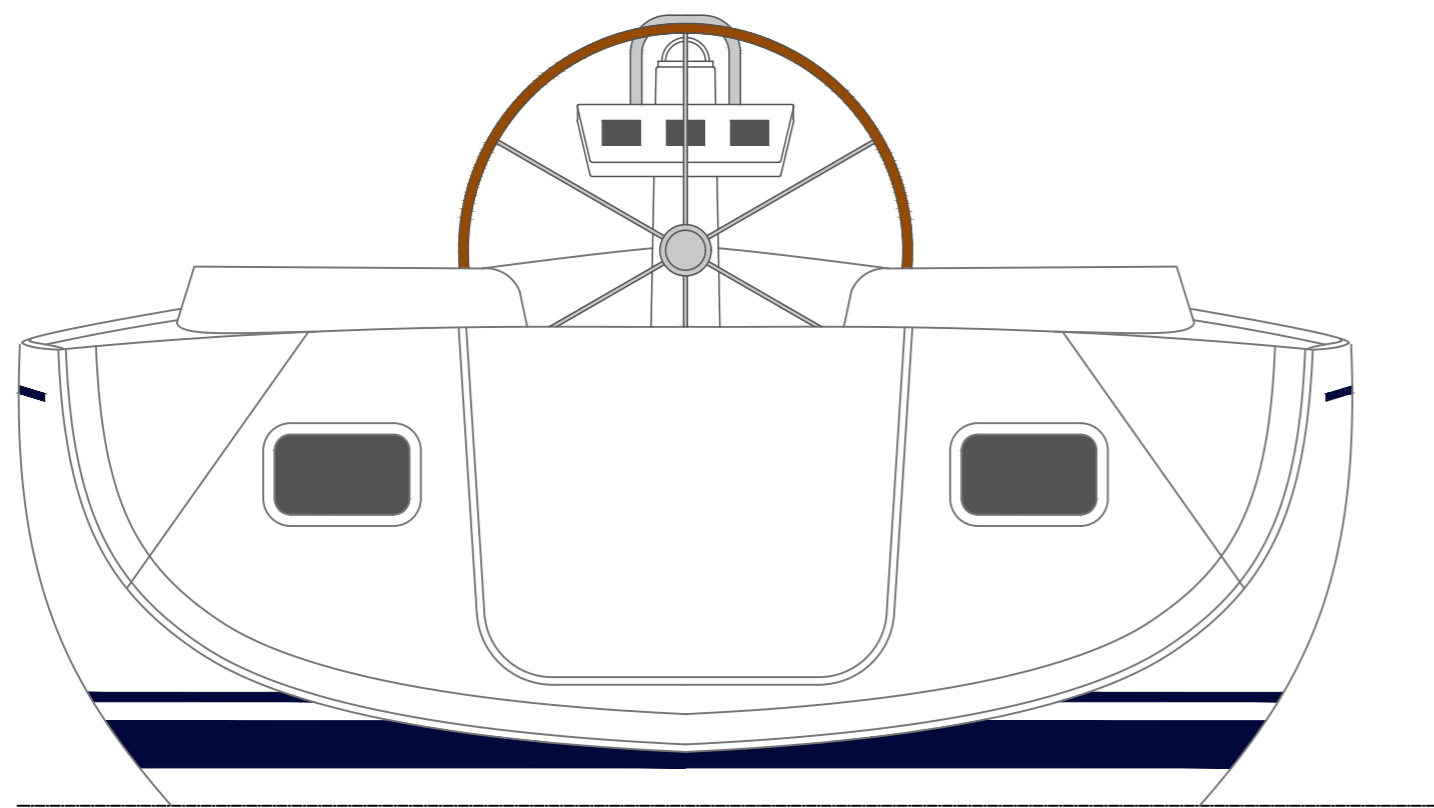
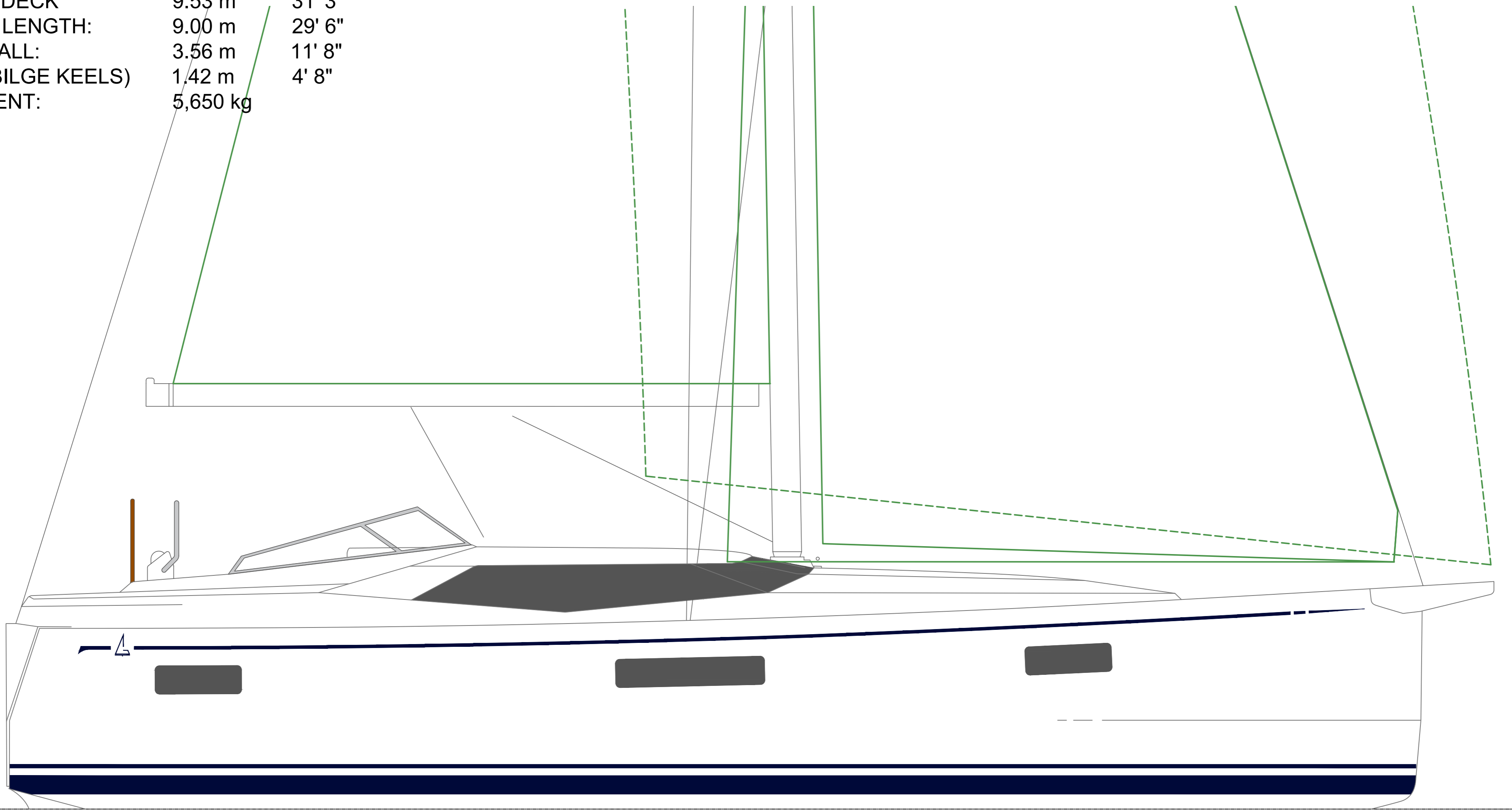

OPTION:  
FORWARD HEADS

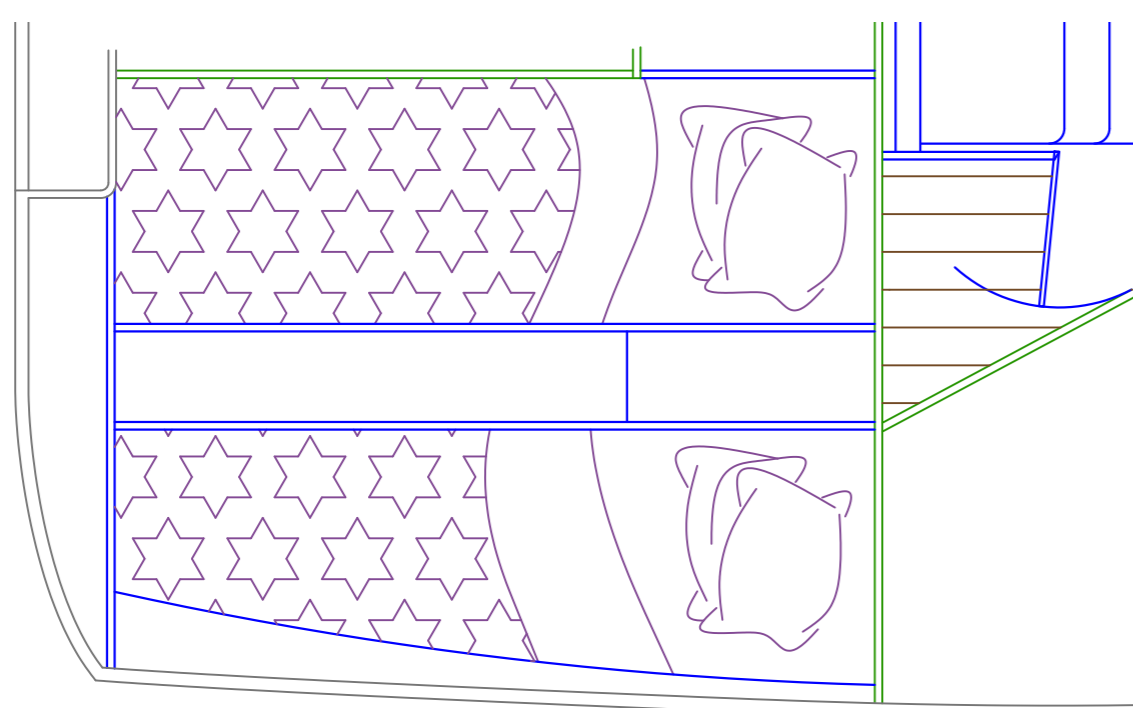
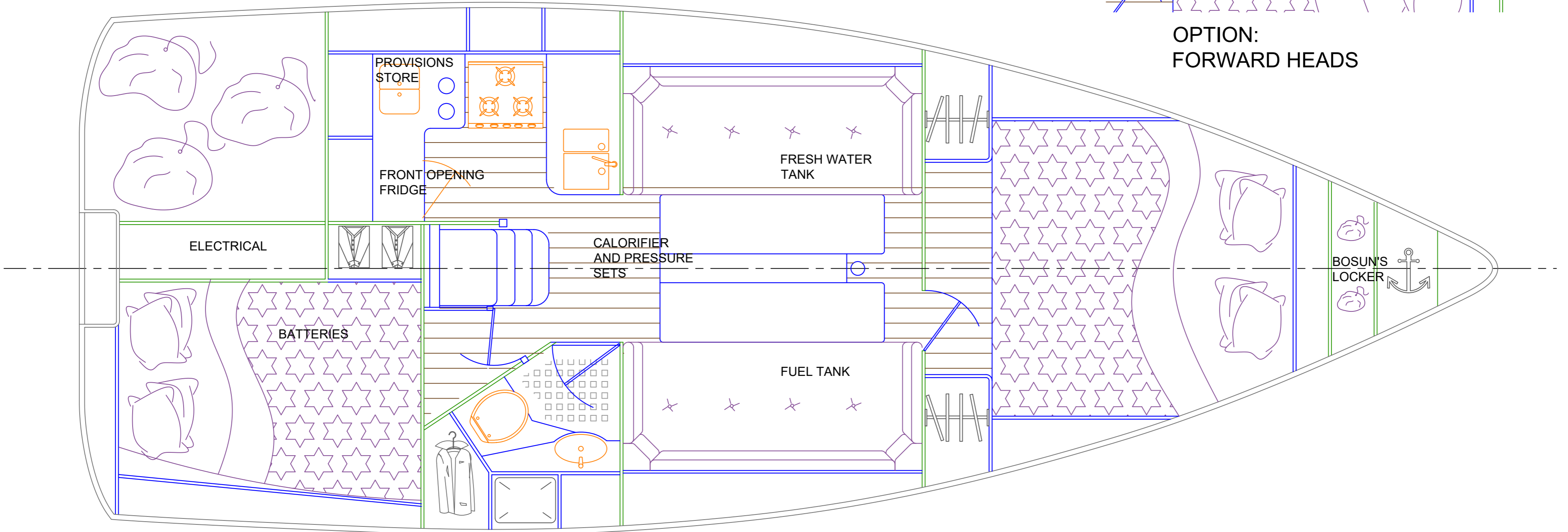

CHOICE:  
TWIN BERTH AFT CABIN

GT Yachts Ltd  
 tel +44 (0)1730 26 45 48  
 email info@gyachts.com  
 web www.gyachts.com



yacht : GT325  
 title : General Arrangement

drawing number : GT07001-601	checked by	checked date
all dimensions in 'mm' unless otherwise stated general tolerance 1.0 mm & 0.5 degree unless otherwise stated		
drawn by : CLC	Scale 1:20 @ A1	Issue G sheet 1 of 1

COMMERCIAL IN CONFIDENCE. THIS DOCUMENT IS CONFIDENTIAL AND MUST NOT BE USED FOR MANUFACTURE OR COPIED OR COMMUNICATED TO ANY OTHER PERSON OR COMPANY WITHOUT THE EXPRESS PERMISSION OF GT YACHTS LTD.