

GT325 PRINCIPAL PARTICULARS

LENGTH OVERALL: 9.97 m 32' 8"
 LENGTH ON DECK 9.53 m 31' 3"
 WATERLINE LENGTH: 9.00 m 29' 6"
 BEAM OVERALL: 3.56 m 11' 8"
 DRAUGHT (BILGE KEELS) 1.42 m 4' 8"
 DISPLACEMENT: 5,650 kg

GT325

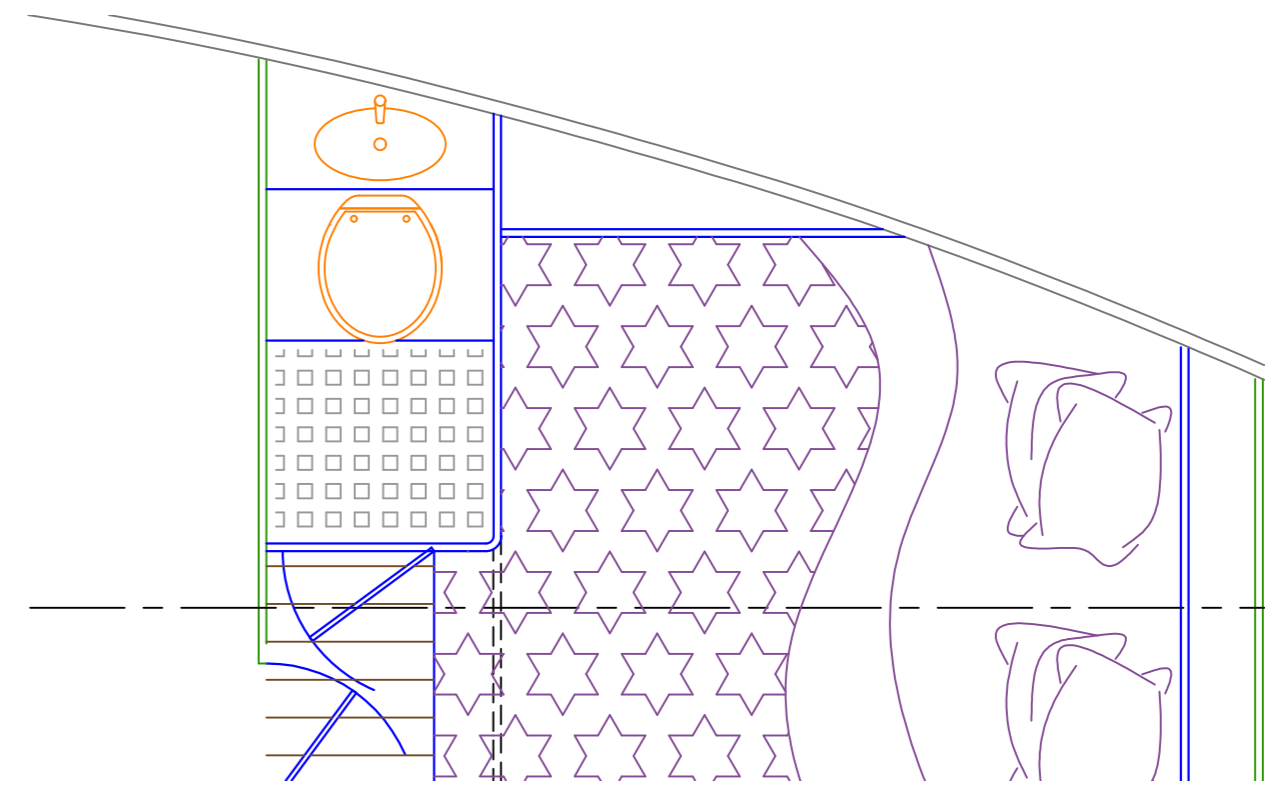
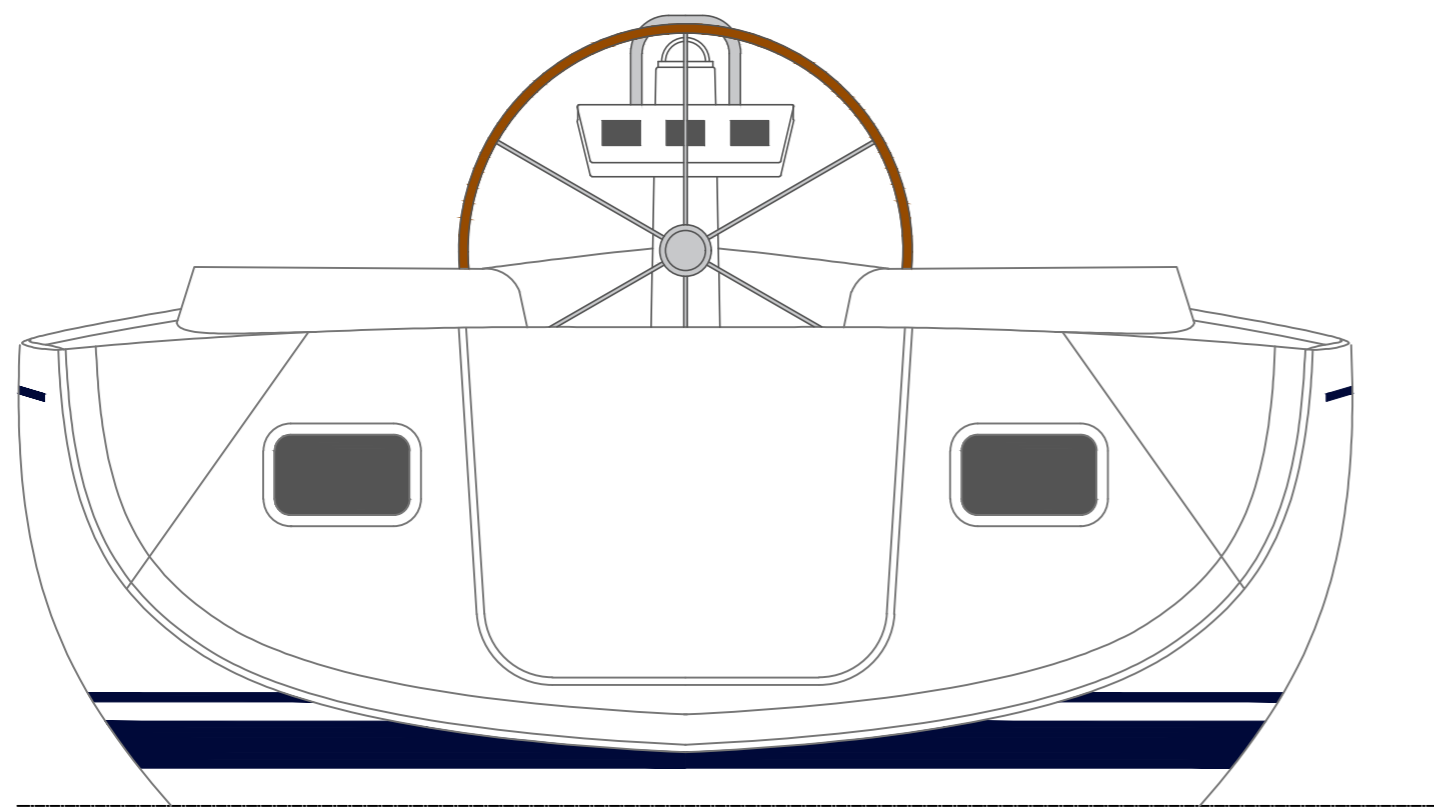
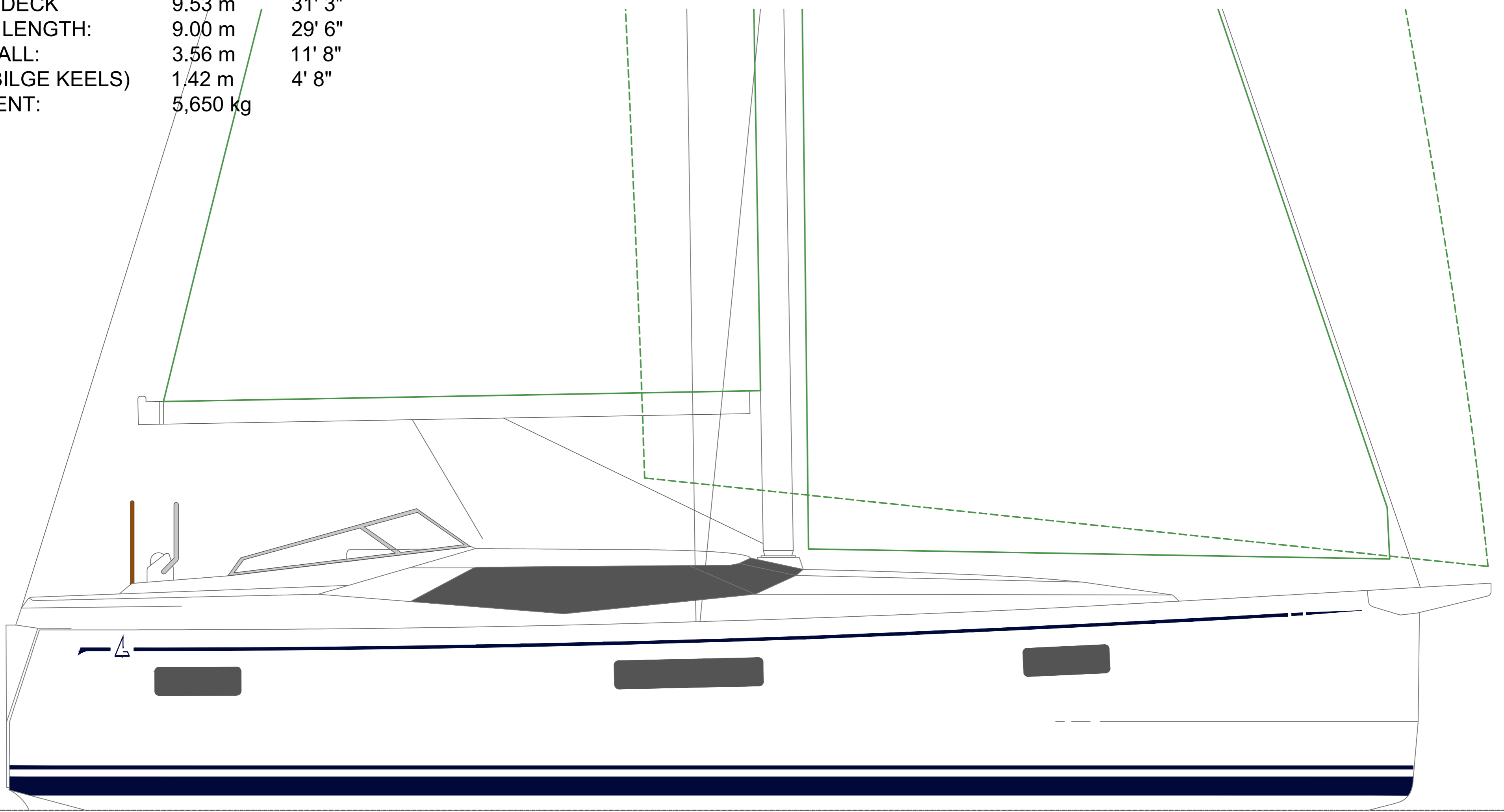

OPTION:
FORWARD HEADS

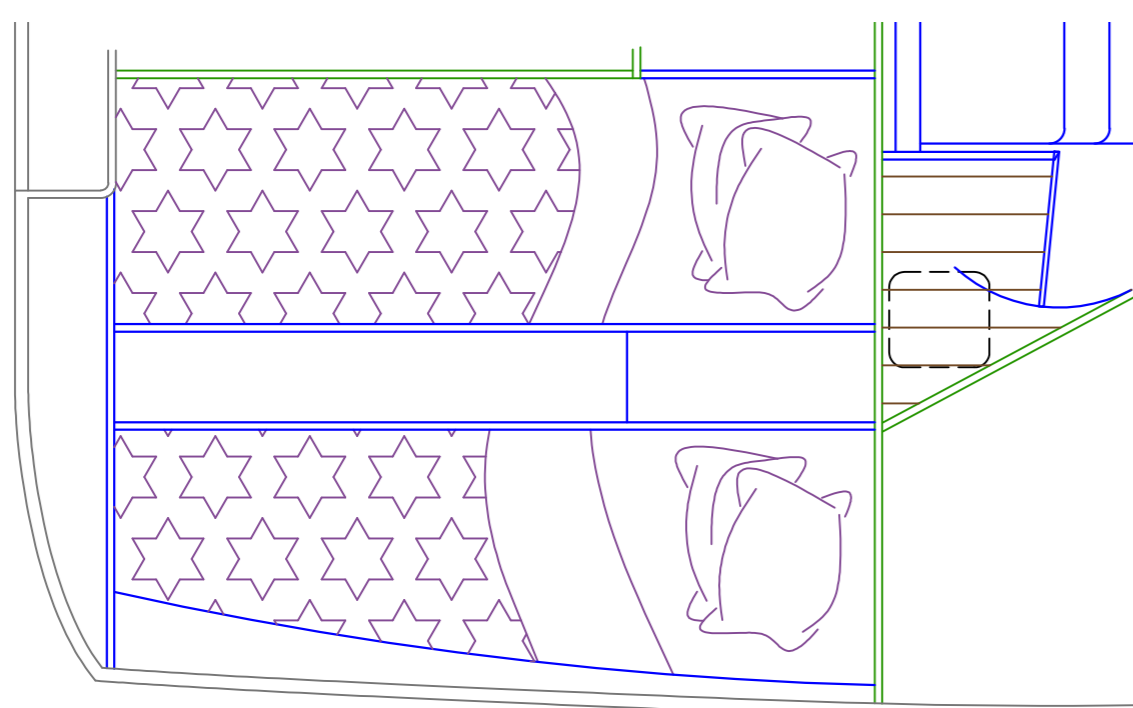
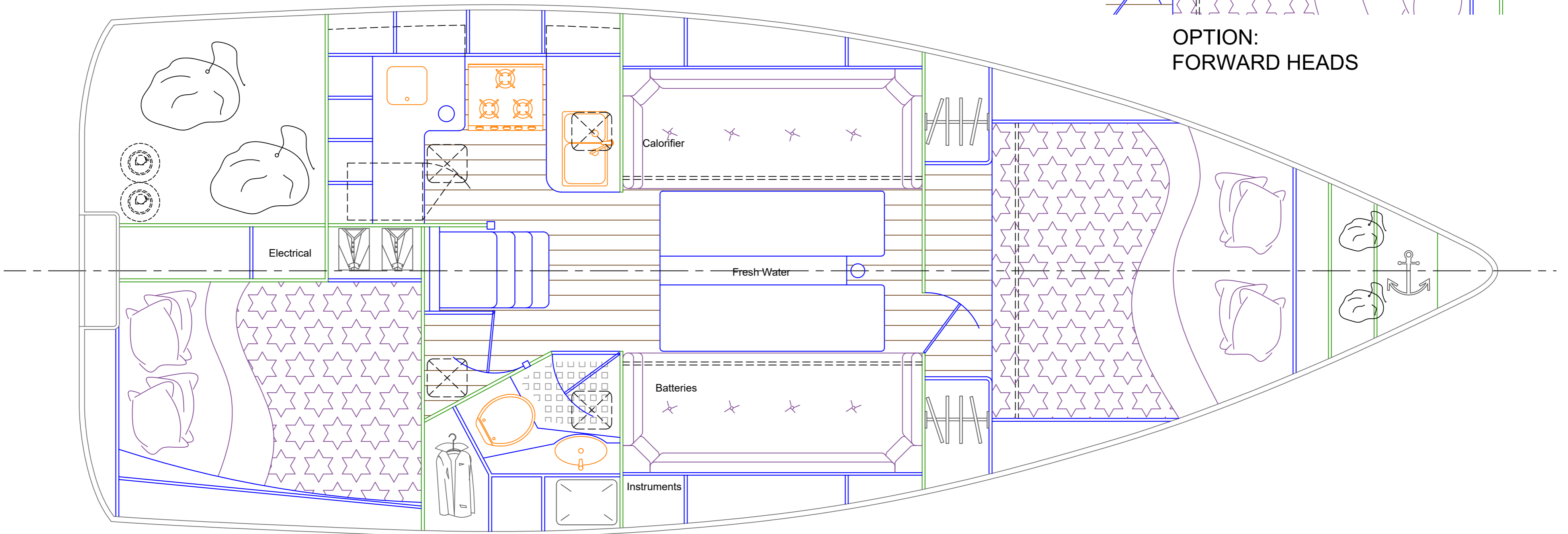

CHOICE:
TWIN BERTH AFT CABIN

GT Yachts Ltd
 tel +44 (0)1730 26 45 48
 email info@gyachts.com
 web www.gyachts.com

GT YACHTS



yacht : GT325

title : General Arrangement

drawing number : GT07001-601

checked by

checked date

all dimensions in 'mm' unless otherwise stated
 general tolerance 1.0 mm & 0.5 degree unless otherwise stated

drawn by : CLC

Scale 1:20 @ A1

Issue F

sheet 1 of 1

COMMERCIAL IN CONFIDENCE THIS DRAWING IS CONFIDENTIAL AND MUST NOT BE REPRODUCED FOR MANUFACTURE OR COPIED OR COMMUNICATED TO ANY OTHER PERSON OR COMPANY WITHOUT THE EXPRESS PERMISSION OF GT YACHTS LTD.